

# 22-0265-ZON1

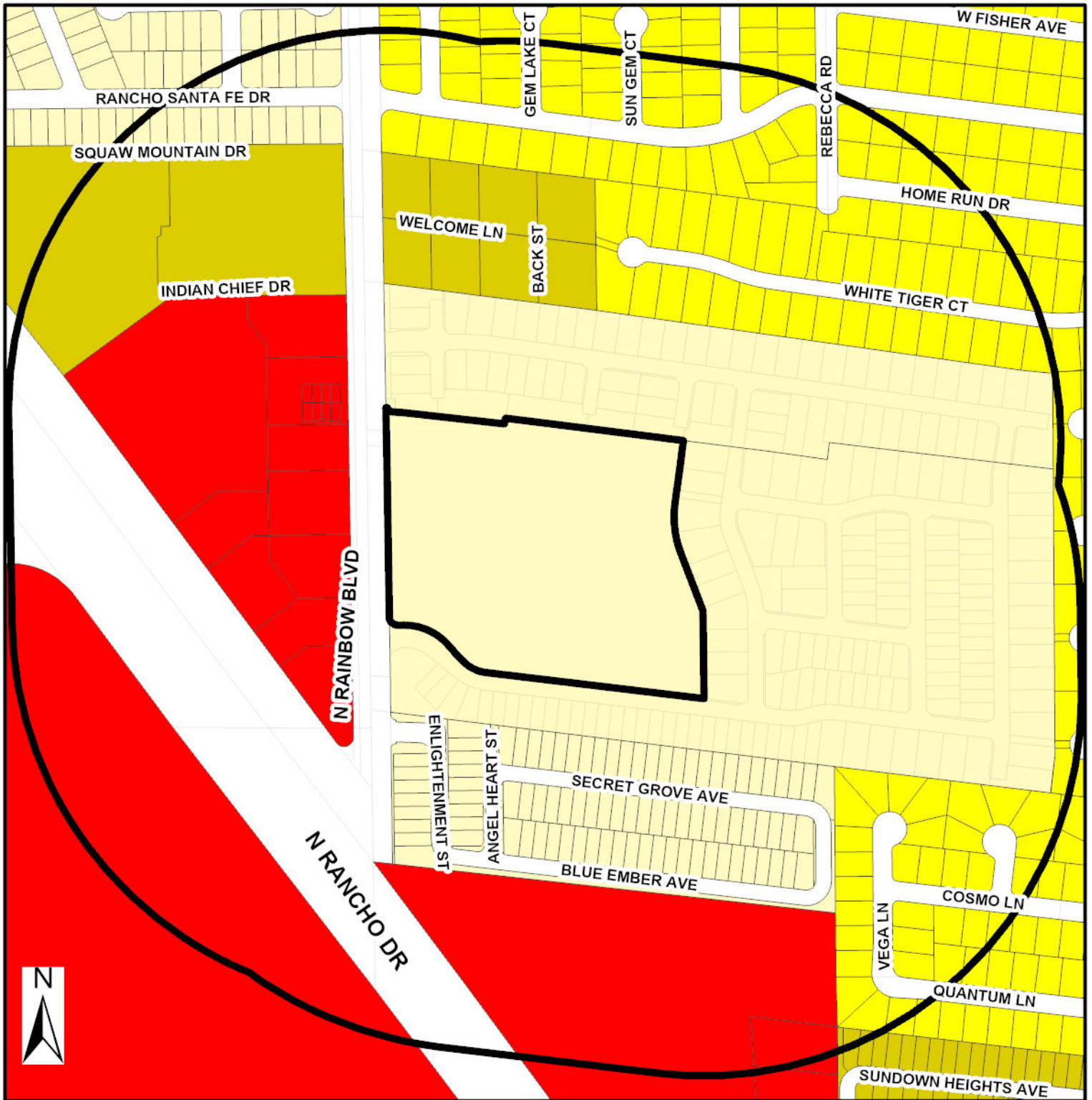

## Zoning

- U - (GPA Designation) Undeveloped
- R-A - Ranch Acres
- R-E - Residence Estates
- R-D - Single Family Residential-Restricted
- R-PD - Residential Planned Development
- R-1 - Single Family Residential
- R-CL - Single Family Compact-Lot
- R-SL - Residential Small Lot
- R-TH - Single Family Attached
- R-2 - Medium-Low Density Residential
- R-3 - Medium Density Residential
- R-4 - High Density Residential
- R-5 - Apartment

- |  |   |
|--|---|
| <span style="display: inline-block; width: 15px; height: 10px; background-color: #FFDAB9; border: 1px solid black; margin-right: 5px;"></span> R-MH - Mobile/Manufactured Home Residence         | <span style="display: inline-block; width: 15px; height: 10px; background-color: #FFDAB9; border: 1px solid black; margin-right: 5px;"></span> P-R - Professional Offices and Parking |
| <span style="display: inline-block; width: 15px; height: 10px; background-color: #FFDAB9; border: 1px solid black; margin-right: 5px;"></span> R-MHP - Residential Mobile/Manufactured Home Park | <span style="display: inline-block; width: 15px; height: 10px; background-color: #FFDAB9; border: 1px solid black; margin-right: 5px;"></span> P-O - Professional Office              |
| <span style="display: inline-block; width: 15px; height: 10px; background-color: #90EE90; border: 1px solid black; margin-right: 5px;"></span> T3-N - T3 Neighborhood                            | <span style="display: inline-block; width: 15px; height: 10px; background-color: #808080; border: 1px solid black; margin-right: 5px;"></span> N-S - Neighborhood Service             |
| <span style="display: inline-block; width: 15px; height: 10px; background-color: #90EE90; border: 1px solid black; margin-right: 5px;"></span> T3-N-O - T3 Neighborhood Open                     | <span style="display: inline-block; width: 15px; height: 10px; background-color: #4B0082; border: 1px solid black; margin-right: 5px;"></span> O - Office                             |
| <span style="display: inline-block; width: 15px; height: 10px; background-color: #4169E1; border: 1px solid black; margin-right: 5px;"></span> T4-C - T4 Corridor                                | <span style="display: inline-block; width: 15px; height: 10px; background-color: #4B0082; border: 1px solid black; margin-right: 5px;"></span> C-D - Designed Commercial              |
| <span style="display: inline-block; width: 15px; height: 10px; background-color: #4169E1; border: 1px solid black; margin-right: 5px;"></span> T4-MS - T4 Main Street                            | <span style="display: inline-block; width: 15px; height: 10px; background-color: #FF0000; border: 1px solid black; margin-right: 5px;"></span> C-1 - Limited Commercial               |
| <span style="display: inline-block; width: 15px; height: 10px; background-color: #4169E1; border: 1px solid black; margin-right: 5px;"></span> T4-N - T4 Neighborhood                            | <span style="display: inline-block; width: 15px; height: 10px; background-color: #FF0000; border: 1px solid black; margin-right: 5px;"></span> C-2 - General Commercial               |
| <span style="display: inline-block; width: 15px; height: 10px; background-color: #9370DB; border: 1px solid black; margin-right: 5px;"></span> T5-N - T5 Neighborhood                            | <span style="display: inline-block; width: 15px; height: 10px; background-color: #FF00FF; border: 1px solid black; margin-right: 5px;"></span> C-PB - Planned Business Park           |
| <span style="display: inline-block; width: 15px; height: 10px; background-color: #9370DB; border: 1px solid black; margin-right: 5px;"></span> T5-M - T5 Maker                                   | <span style="display: inline-block; width: 15px; height: 10px; background-color: #9370DB; border: 1px solid black; margin-right: 5px;"></span> C-M - Commercial/Industrial            |
| <span style="display: inline-block; width: 15px; height: 10px; background-color: #9370DB; border: 1px solid black; margin-right: 5px;"></span> T5-MS - T5 Main Street                            | <span style="display: inline-block; width: 15px; height: 10px; background-color: #0000FF; border: 1px solid black; margin-right: 5px;"></span> M - Industrial                         |
| <span style="display: inline-block; width: 15px; height: 10px; background-color: #4B0082; border: 1px solid black; margin-right: 5px;"></span> T5-C - T5 Corridor                                | <span style="display: inline-block; width: 15px; height: 10px; background-color: #A9A9A9; border: 1px solid black; margin-right: 5px;"></span> C-V - Civic                            |
| <span style="display: inline-block; width: 15px; height: 10px; background-color: #800080; border: 1px solid black; margin-right: 5px;"></span> T6-UC - T6 Urban Core                             | <span style="display: inline-block; width: 15px; height: 10px; background-color: #808080; border: 1px solid black; margin-right: 5px;"></span> P-C - Planned Community                |
| <span style="display: inline-block; width: 15px; height: 10px; background-color: #800080; border: 1px solid black; margin-right: 5px;"></span> T6-UG - T6 Urban General                          | <span style="display: inline-block; width: 15px; height: 10px; background-color: #D8BFD8; border: 1px solid black; margin-right: 5px;"></span> T-D - Traditional Development          |
| <span style="display: inline-block; width: 15px; height: 10px; background-color: #800080; border: 1px solid black; margin-right: 5px;"></span> T6-UG-L - T6 Urban General Limited                | <span style="display: inline-block; width: 15px; height: 10px; background-color: #FF00FF; border: 1px solid black; margin-right: 5px;"></span> PD - Planned Development               |
|  | <span style="display: inline-block; width: 15px; height: 10px; background-color: #FFDAB9; border: 1px solid black; margin-right: 5px;"></span> T-C - Town Center                      |

**FROM R-CL  
TO R-4**



GIS maps are normally produced only to meet the needs of the City. Due to continuous development activity this map is for reference only. Geographic Information Systems Planning & Development Dept. 712-225-6301

Date: Tuesday, May 31, 2022